

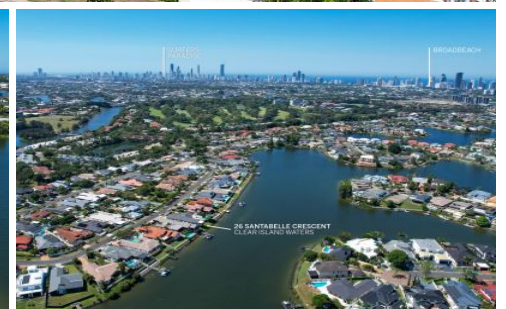

26 SANTABELLE CRESCENT
CLEAR ISLAND WATERS

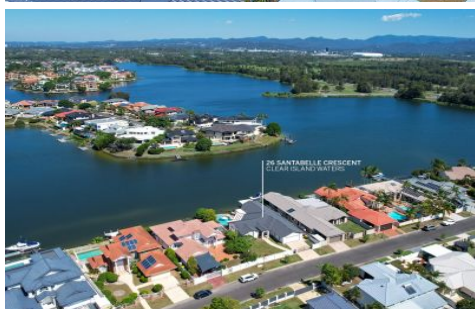

26 Santabelle Crescent Clear Island Waters QLD

5 🛏️ 2 🚿 2 🚗

Single level 5 bedroom home located on a desirable 841m² allotment with an impressive 20.4 metres of water frontage.

This comfortable family home welcomes you with open arms from the very moment you step inside through its new front doors. The inviting and homely atmosphere makes it the perfect place for any family to call home.

The interiors have been freshly painted, and new carpets have been laid throughout, creating a seamless and sophisticated finish that's sure to impress.

With a newly installed ducted air conditioning system you'll be able to enjoy comfort all year round. Get ready to enjoy a stylish family lifestyle with a vista that you'll fall in love with, and never want to leave.

Price : \$ 2,100,000
Building Size : 341 sqm
Land Size : 841 sqm
View : <https://www.astras.com.au/sale/qld/gold-coast/clear-island-waters/residential/house/7494555>



Christine Demchenko
07 5593 2038

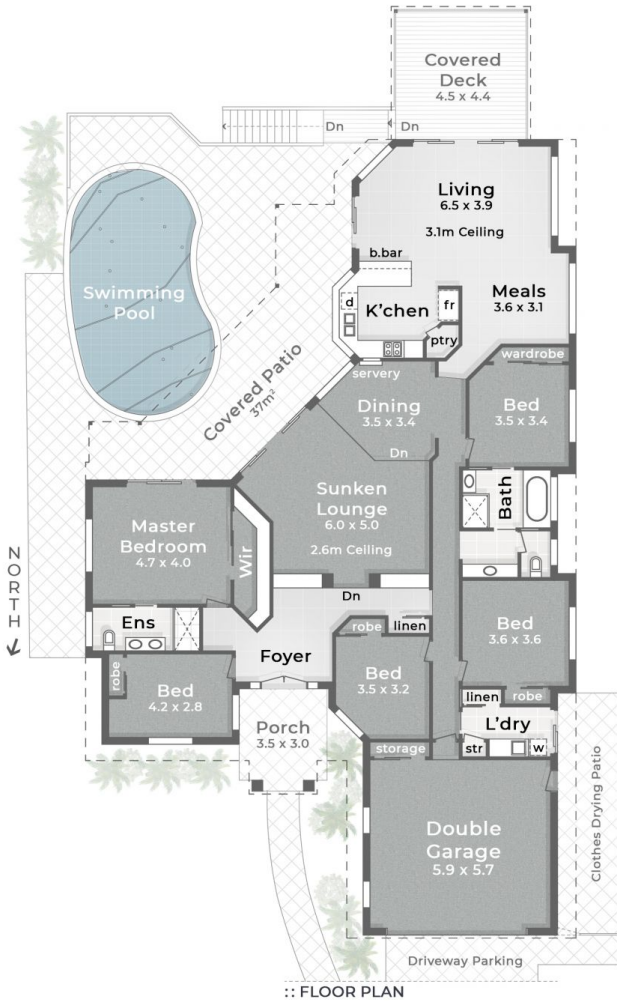

:: FLOOR PLAN

SITE PLAN LEGEND

- 1. Driveway Parking
- 2. Entry Porch | 3. Covered Patio
- 4. Swimming Pool | 5. Covered Deck
- 6. Waterfront Yard



19.8m
**SANTABELLE
CRESENT**

ASTRAS
prestige property

Christine Demchenko
0414 798 759

26 Santabelle Crescent
CLEAR ISLAND WATERS

- 841m²
- 5 Bed
- 2 Bath
- 2 Car + Off-Street

Internal 274m²
Patio, Deck & Porch 67m²
Total 341m²

pdc.

This is not a legal document therefore all measurements and information provided is subject to survey. No permission is given to use or alter this Floor Plan without the consent of Pure Design Concepts. The overall presentation style, layout, imagery, fonts, background, colours and terminology has been originally created by PDC and is subject to strict copyright. No ownership is taken of building design. Find out more at puredesignconcepts.com.au